

1



**WALLACE
COMMUNITY
COLLEGE**
WALLACE CAMPUS
1141 WALLACE DRIVE
DOTHAN, AL 36303

HWY 134
 ← to Midland City to Headland →

- | | | | |
|-----|---|-----|---|
| 177 | Adult Education, Cosmetology Annex | 55 | Grimsley Hall (GH) |
| 177 | Air Conditioning and Refrigeration (ACR) | | ADA Services, Admissions and Records, Advising Center, |
| 230 | Industrial Systems Technology (INT) | | Business Office, Campus Dean, Counseling, Financial Aid, |
| 14 | Automotive Technology (ASE) | | Instructional Affairs, Physical Plant, Testing Services, |
| 206 | Automotive Technology Annex | | TRIO Student Support Services |
| 60 | Cabinetmaking | 113 | Hamm Library (LRC) |
| 100 | Campus Police Station | 671 | Heersink Family Health Science Building |
| 110 | Center for Academic Success (CAS) | | Associate Degree Nursing (ADN), Emergency Medical |
| | Mathematics Lab, The Writing Center | | Services (EMS), Medical Assisting Technology (MAT), |
| 400 | Cherry Hall (CY) | | Physical Therapist Assistant (PTA), Practical Nursing (PN), |
| | Bence Theatre, Art, Music, Speech | | Radiologic Technology (RAD), Respiratory Therapist (RPT), |
| 418 | Coach Johnny Oppert Athletic Development Facility | | Surgical Technology (SUR) |
| 502 | Community Enrichment Center, Wallace Foundation | 515 | Lineworker Program |
| 73 | Computer Technology Center (CTC) | 610 | Maintenance |
| | Computer Information Science (CIS), Information | 537 | Printing and Duplication |
| | Technology Services (ITS), Mathematics | 371 | Rane Hall (RH) |
| 125 | Cosmetology (COS) | | Business, Humanities, Wheelless Auditorium |
| 36 | Criminal Justice (CRJ) | 101 | Science Building (S) |
| 81 | Cunningham Hall (CH) | 473 | Sheet Metal |
| | Bookstore, Cafeteria, Public Relations & Marketing, | 588 | Shipping and Receiving |
| | Student Center, Student Life | 503 | Storage |
| 177 | Electrical Technology (ELT) | 188 | Transportation |
| 554 | Esthetics | 25 | Wallace Hall (WH) |
| 191 | Field House | | Child Development, English, Institutional Effectiveness, |
| 401 | Gary Hall | | Human Resources, Office of the President, Office of |
| | Engineering Graphics, Workforce Development | | the Vice President |
| | | 125 | Welding Technology (WDT) |

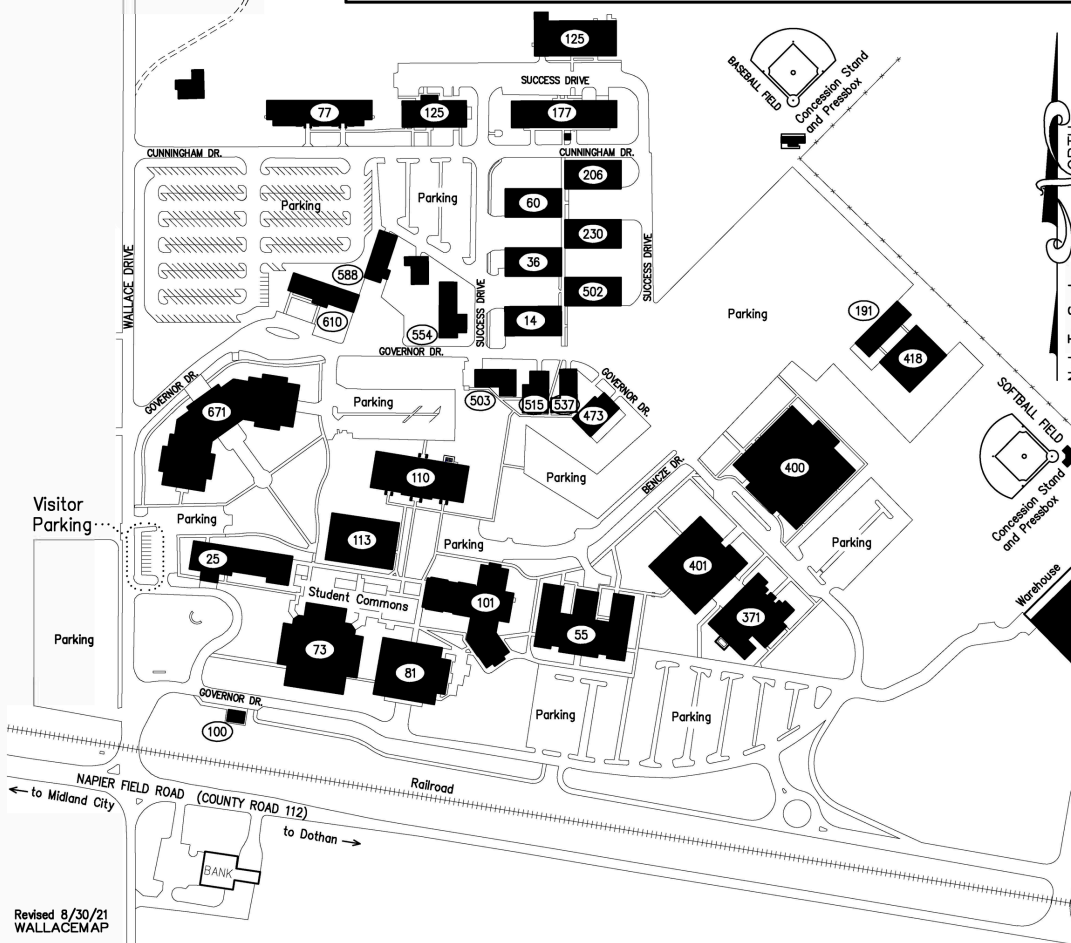

Not To Scale

Revised 8/30/21
WALLACEMAP